

Installation Manual

1.

Step 1:

Open the metal cover by disengaging the lock latches located at the rear side.

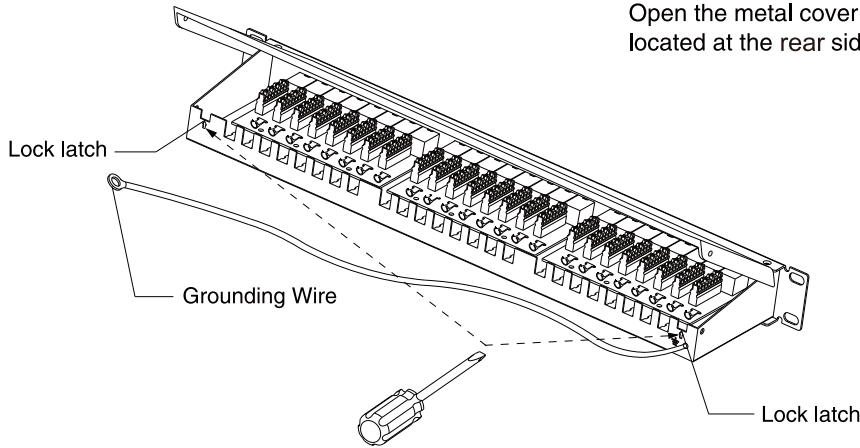

2.

Step 2:

Strip back approximately 45mm (1.8in) of cable jacket using a cable jacket stripper. Fold back the braid shield approximately 45mm (1.8in).

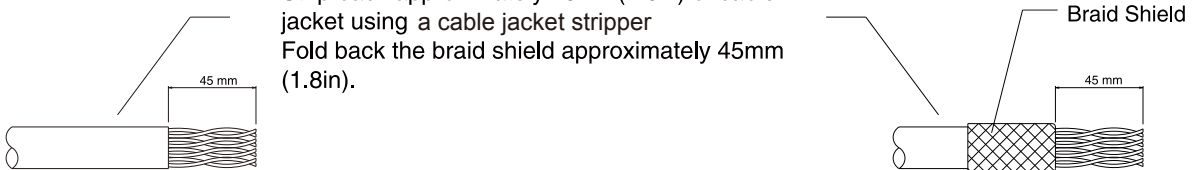

3.

Step 3:

View the color code label on the 110/krone connector to determine proper location of conductors based upon preferred wiring scheme.

Place the first pair according to color code, Position punch down tool over pair, and press down to seat the wires. As with the first pair, position and terminate each subsequent pair. Snap the aluminum foil/drain wire/braid shield with fold back from cable to cable holder, Then compress tightly cable holder.

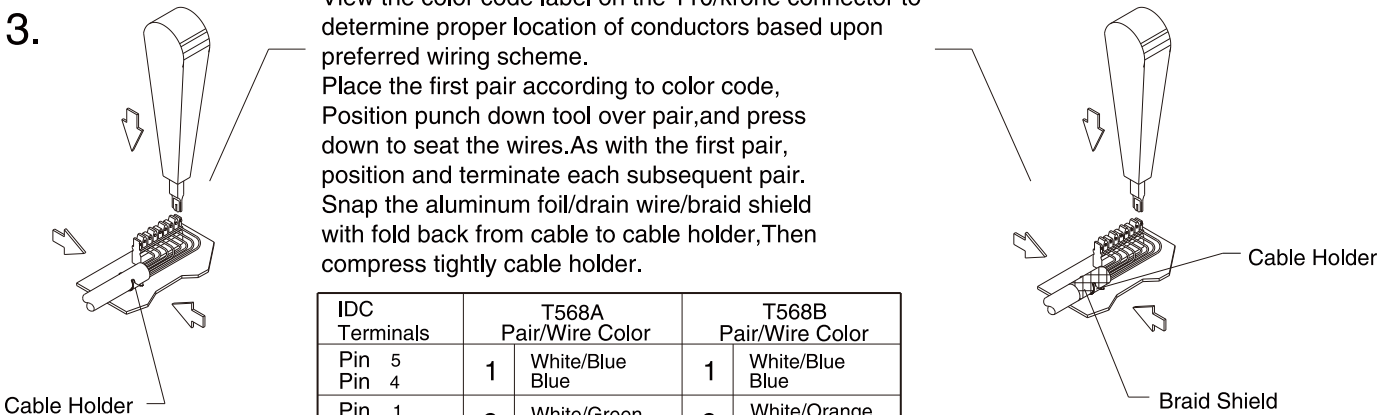

IDC Terminals	T568A Pair/Wire Color	T568B Pair/Wire Color
Pin 5 Pin 4	1 White/Blue Blue	1 White/Blue Blue
Pin 1 Pin 2	2 White/Green Green	2 White/Orange Orange
Pin 3 Pin 6	3 White/Orange Orange	3 White/Green Green
Pin 7 Pin 8	4 White/Brown Brown	4 White/Brown Brown

4.

Step 4:

Secure the cables to the cable bracket using the cable ties provided. Place the metal cover on to bottom case.

